

# YuStudio: Class set-up guide



1

Log-in to Charanga as the class teacher

Go to 'MY WORKSPACE'

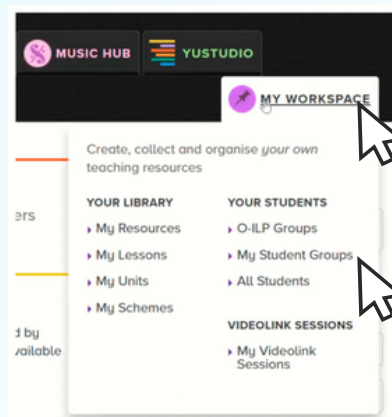

2

Select 'My Student Groups' and then click on 'Create group'

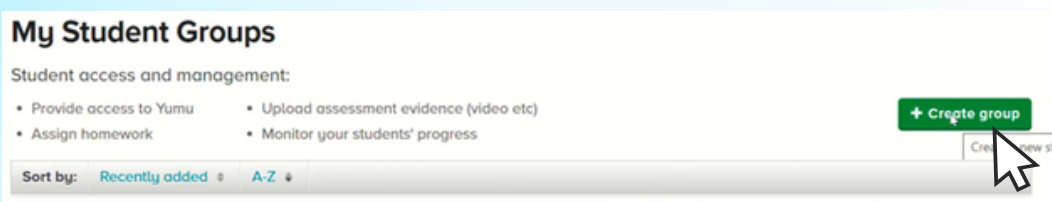

Name the group (e.g. your class name)

3

Select 'Add students'

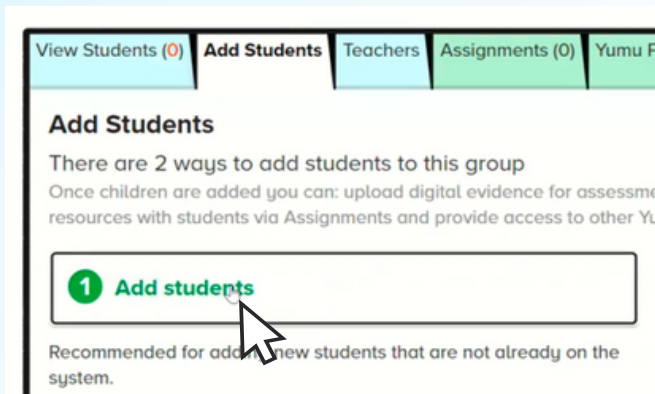

4

### Add your students' names

You can copy-and-paste their names as one list from another file or enter them one-by-one, manually.

*(If using the copy-and-paste option, click in the first box and use Ctrl+V to paste and it will populate the whole list. Please note that only the first three boxes will appear filled but it will have done all of them - it just doesn't always show it!.)*

**Enter the students' names**  
You can type directly into the grid below, or copy and paste a list of Word document or spreadsheet.

First name	Last name
X	

### Once all your students' names are there, click on 'Add Students'



This will create individual *YuStudio* accounts for all of them.

5

### 'View Students' options

- There is a letter that can be sent home to each student's family which includes some introductory information about *YuStudio* along with the student's individual username and password.
- There is a printable sticker sheet with each student's username and password - you might find it useful for students to stick these in a work book for easy reference in case they forget their log-in details!
- We'd recommend you also use the option to download an Excel spreadsheet with all the students' usernames and passwords to save somewhere safe for your reference!

**View Students (1)** Add Students Teachers Assignments (0) Yumu Packages (0) Yumu Activity Assessment Evidence (0) Options

**View Students**  
To add more students click 'Add Students'.  
You can reorder the table by clicking on the column names.

Welcome letter for every student with their username and password
 Printable sticker sheet, with each student's username and password. You can choose your sticker sheet format on the next page (opens in a new tab)
 Spreadsheet of usernames, passwords and userno state for all

Select all Select none Remove selected students from this group Delete selected student accounts

Select	First name	Last name	Welcome Letter	Login details	Assessment Evidence	Yumu Activity
<input type="checkbox"/>	EMC	XXXXXXXXXX	Login letter	View / Edit	No items	Yumu Activity

Select all Select none Remove selected students from this group Delete selected student accounts

Now you can add the *YuStudio* app to your students' accounts.

Click on the 'Primary' (or 'Freestyle') tab in the top menu bar

6

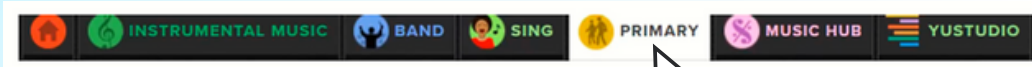

Select 'Creative Apps' and then select the *YuStudio* icon

In the next window, click on the 'More' button (shown with three dots) next to the *YuStudio* app.

7

Then click on '+ Group'

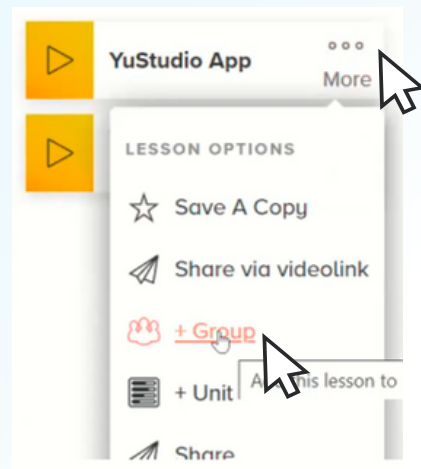

In the pop-up window that follows, select the class/group you created earlier and click 'Save Changes'.

8

When your students log-in, they will now have the *YuStudio* icon visible - this will take them direct to the app.

The set-up for this group of students is now complete.

